

ZOOM Nitro® & NEXEO | HDX™ Pre-Installation Checklist

The NEXEO | HDX and ZOOM Nitro systems are powerful, industry-leading communication systems that maximize productivity and profits. The NEXEO | HDX and ZOOM Nitro systems may only be installed in a correctly configured site. The following requirements must be in place before installation begins to ensure trouble-free system functionality for many years to come.

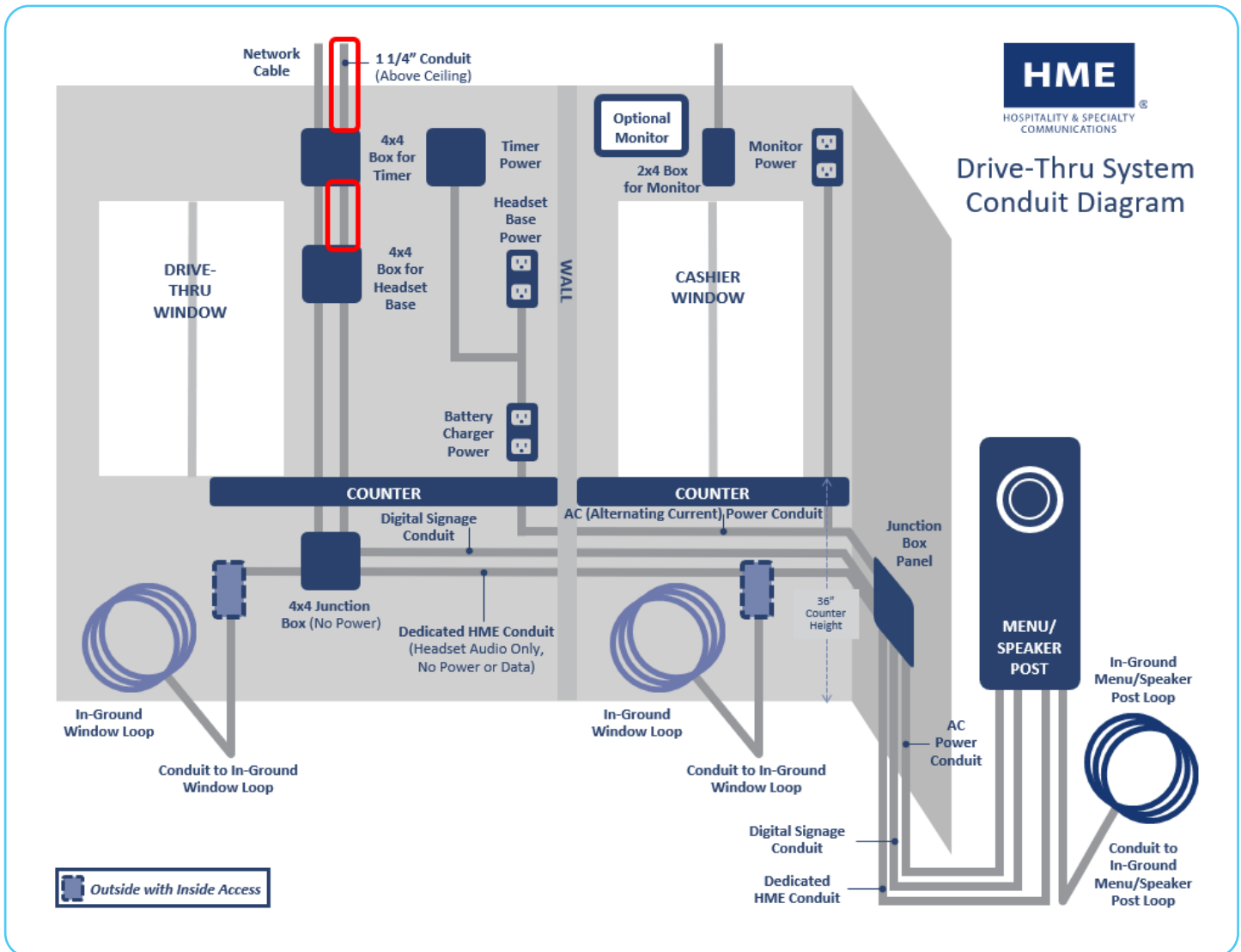

1. Dedicated Conduits:

- 1 ¼-inch inner diameter conduit is recommended for the stub-out above the ceiling from the base and timer box (TSP - Timer Signal Processor).
- 1-inch inner diameter conduit may be used for all other internal and external runs. Local/state regulations may vary.
- Please see the image above for a diagram of the conduit layout.
- Straight runs are recommended. If not possible, use the most minimal bend possible. 90-degree turns are not permitted.
- No other wiring or cable may share the HME conduit connected to the speaker post.
- If store is multi-lane, each lane will need its own dedicated conduit.

2. Permanent Power & Outlets:

- Electricity from the local utility must be connected at the site and tuned on before installation of any HME equipment. Voltage, amperage, and outlets may vary by region or franchise.
- No extension cords are to be used between the electrical outlets and HME equipment.
- Please note the layout, number, and locations of required electrical outlets in the diagram above.

3. Finished Walls:

- The walls where the HME equipment and conduits will be installed must be finished and/or painted with the final coat.

4. Network:

- A standard rack for mounting HME equipment must be provided a permanent location before installation.
- Network must be fully operational.
- Network switch must be installed.
- Open ports must be available for all HME equipment to be installed.

5. Detection Loops:

- For new or remodeled restaurants, prefabricated loops that will be installed by a contractor, must be in place, prior to HME equipment installation.
- For established stores without existing loops, installation of saw-cut loops must be completed for HME equipment to operate.
- Loop leads should be a minimum of 18".
- Loops must fall between 100-150 microhenries and approximately 1 ohm.
- HME loops are strongly recommended for optimal functionality of HME systems.

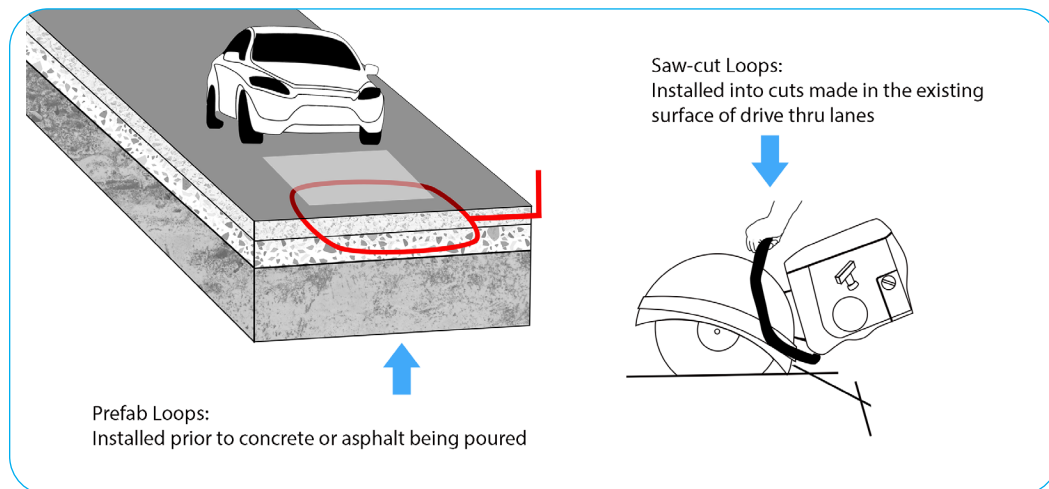

6. Drive-Thru Lane Surface:

- Lane concrete or asphalt must be poured and completely cured (3-7 days) prior to HME equipment installation.
- Drive-thru lane must be 100% clear of tools and materials to facilitate HME equipment installation.

7. Speaker Posts/ Order Confirmation Board/ Menu Board:

- Speaker post, speaker, and microphone location must be completely installed, including the conduit described above, before installing HME equipment.
- Confirm that the dimensions of the speaker post, speaker, and microphone location will effectively accommodate HME speaker components.
- To confirm dimensions of the components, refer to the installation guide (pages 19 - 24) linked below: <https://www.hme.com/techPdfs/D002557%20Rev%20K.pdf>

8. Point-Of-Sale (POS) System:

- POS System and monitors must be completely installed prior to HME installation to ensure visibility and prevent improper placement of HME equipment.

For help, call 800.848.4468 (options 1, 2, and 3) or email: support@hme.com

3 of 3

HME Training Portal

Find instructional videos, documents, and guides.

© 2024 HM Electronics, Inc. The HME logo and product names are trademarks or registered trademarks of HM Electronics, Inc. All rights reserved. 6.3.24

www.hme.com/training
Scan to Visit >

